

BONECO

BONECO P2261

Foreword

Congratulations on purchasing the BONECO P2261 Air Purifier!

The air in living and office spaces is often burdened with

- stirred up dust,
- numerous pollutants,
- smoke and smells,
- allergy-causing materials, such as pollen, pet hair and mites.

Possible effects on health range from weakness, tiredness and poor concentration to asthma attacks, allergic reactions and serious illnesses. The term Sick Building Syndrome was coined for the health consequences that ever more people are suffering from.

General information

The use of an Air Purifier does not replace the regular ventilation of rooms. An Air Purifier may improve the air quality, but cannot remove the causes of the burden of pollutants. If you suspect that your health problems are related to influences in living and office spaces, then have a thorough medical examination and test especially for pollutants in the body. Depending on the findings, a biological examination of the rooms in the building may be recommended.

Safety instructions

- Read the instructions for use carefully before putting the appliance into operation, and keep in a safe place for later reference.
- Only use the appliance in living spaces and within the specified technical data. Incorrect use can place health and life in danger.
- Children cannot recognise the dangers associated with using electrical devices. For this reason, always supervise children when they are in the vicinity of a running appliance (Fig. 1).
- Persons who have not familiarised themselves with the instructions for use, as well as children and persons under the influence of medicines, alcohol or drugs, must not operate the unit, or do so only under supervision.
- Do not use the appliance if the power cable is defective (2) or the appliance has been damaged by, e.g., falling over (3).
- The appliance may only be put into operation in a completely assembled state.
- Repairs to electrical appliances may only be carried out by specialist engineers (4). Non-specialist repairs can pose significant hazards to the user.
- Never remove the power plug from the mains socket by pulling on the cable or with wet hands.
- Place the appliance on a level, dry surface only (5).
- Never immerse the appliance in water or other liquids.
- Place the appliance so that it cannot be knocked over (6).
- Remove the power plug when the appliance is not in use.

- Do not cover the cable with a carpet or other objects. Place the unit so that you cannot trip over the cable.
- Do not operate the appliance in rooms containing flammable goods, gases or vapours.
- Do not place the appliance in the rain, and do not use it in damp rooms.
- Do not insert any foreign objects into the appliance.
- Never sit on the appliance, and do not place any objects on it.
- The cable must never be trapped by a door threshold or crushed by other heavy objects (7)!



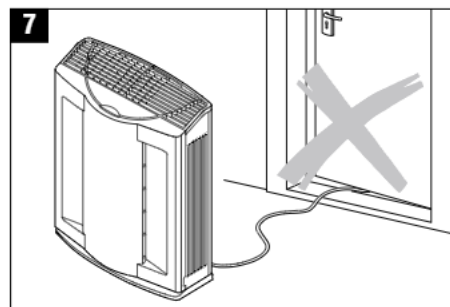
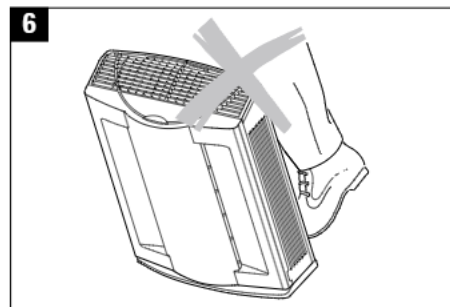
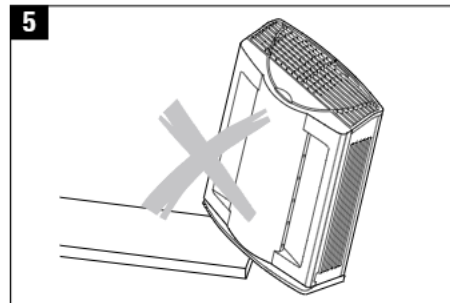
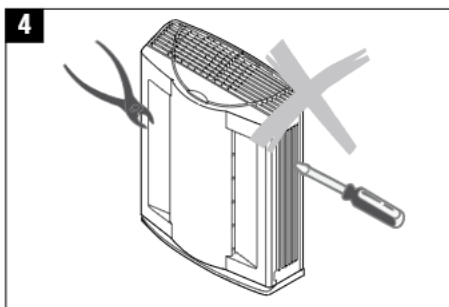
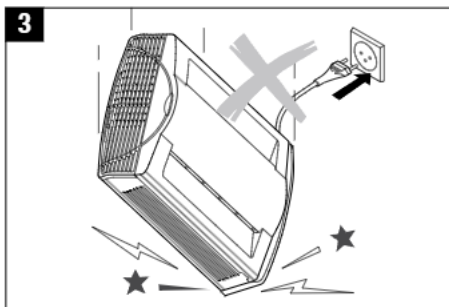
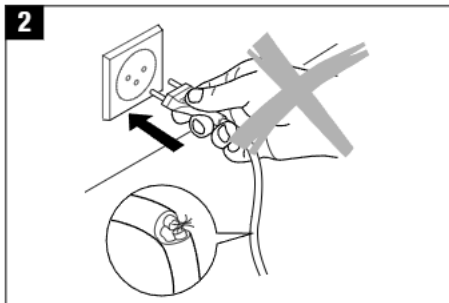

Unpacking

Pull the appliance carefully out of the cardboard box and remove all packaging elements from the housing.

Use the original packaging to store the appliance if you do not use it throughout the year.

Note



The filters are packed in polyethylene bags to ensure their effectiveness. These bags must first be removed before putting the Air Purifier into operation! To do this, please follow the «Instructions for changing the filter».

Putting into operation

- Place the appliance on the floor, or on a level, dry surface in the room.
- The top of the unit is not a storage shelf!
- Never allow children to play unsupervised in the vicinity of the appliance!
- Pay proper attention to easy accessibility and sufficient space for servicing and cleaning the appliance.
- Check the rating plate on the underside of the appliance: the voltage and frequency must be the same as the local mains voltage. If different, do not connect the appliance to the mains and inform your supplier.
- The appliance can be operated by pressing the buttons on the operating panel of the appliance or by using the remote control.

Description of the appliance

The appliance filters the smallest particles from the air, thus ensuring clean and healthy air at home or in the office. With its unique filter system, the appliance efficiently reduces the load of pollen, dust, pet hairs, mites, smoke and smells in the air, creating an indoor climate in which allergy sufferers in particular are able to breathe.

Quality features

- The HEPA filter (High Efficiency Particulate Air Filter) ensures the best-possible reduction in pollutants by retaining 99.97% of particles >0.3 micrometres. By comparison, the tip of a hair has a size of 70-100 micrometres.
- The active carbon filter removes gaseous pollutants as well as bad odours.
- The ioniser noticeably activates the air.
- 3 operation modes guarantee ideal air circulation.
- The easy handling means good user-friendliness.

Ioniser function

Air-borne pollution and electronic devices such as computers or televisions result in a reduction of negative ions in the air. If the air has too few negative ions it feels used and sticky. By replacing the depleted negative ions, it feels noticeably more clean and fresh. The negative ions bind with the dust particles to form so-called clusters. These can be retained much more effectively by the HEPA filter.

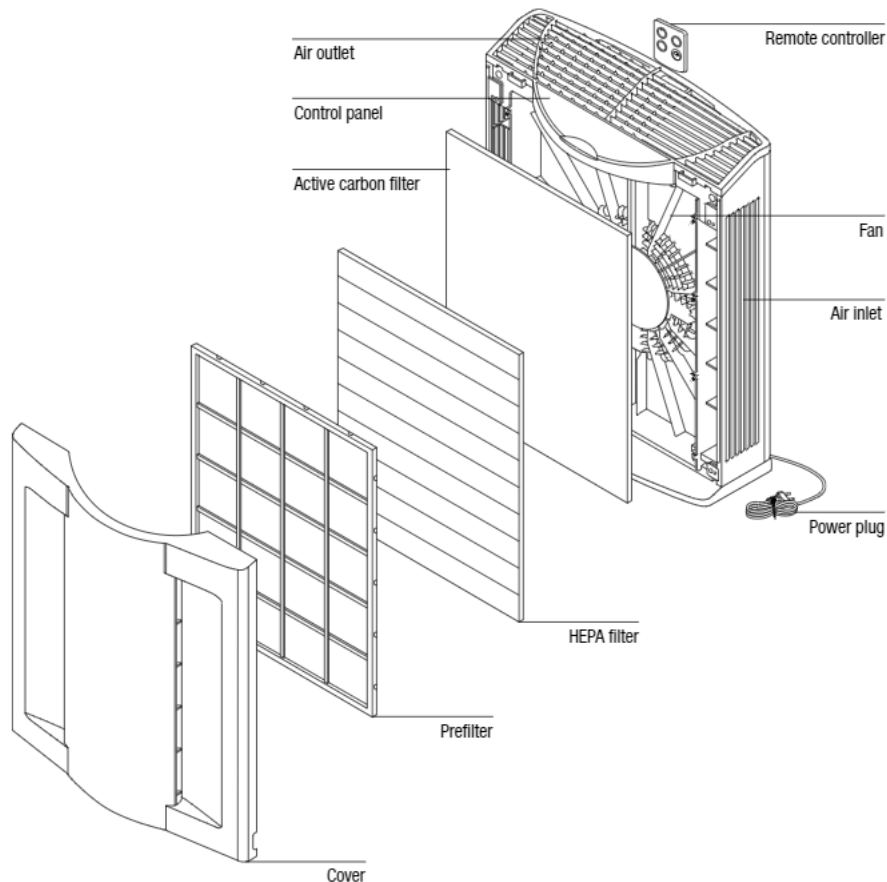

Operation of the P2261

A) Switching on

A single press of the combined «ON/SPEED» button (A) switches on the appliance.

B) Switching off

A single press of the «OFF» button switches off the appliance.

C) Setting the modes

The operating light (C) lights up in one of the modes: «LO», «MID» or «HI». The following modes can be selected by repeated pressing of the combined «ON/SPEED» button (A):

- Mode I (LO):
Particularly quiet, suitable for use at night
- Mode II (MID):
Permanent operation with moderate air circulation
- Mode III (HI):
Quick purifying with high air circulation

D) Ioniser function

The ioniser function is activated by pressing the «ION» button (D) and displayed by the operating light (E).

F) Timer

The timer function is switched on by pressing the «TIMER» button (F). The button can be used to set the required operating time to 1, 2, 4 or 8 hours, or to deactivate the function. The selected operating time is shown by the display (G).

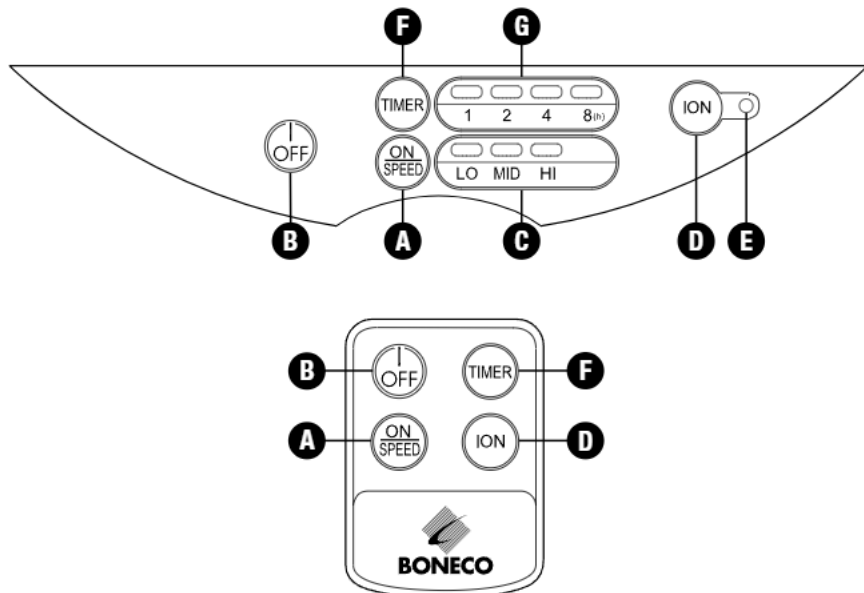

Changing the filter

Regular replacement of the filter is essential for hygienic, problem-free operation! The recommended intervals between filter changes are guidelines. Make a note of the date on which you change the filter.

- Prefilter (a): does not need changing
- HEPA filter (b): change once a year. Check the HEPA filter from time to time. Early filter replacement is recommended in the case of obvious discolouration (brown or grey) or visible blockages.
- Active carbon filter (c): replace every 3-6 months. If in doubt, rely on your nose: a saturated active carbon filter has an unpleasant smell.

Instructions for changing the filter

- Press the «OFF» button, i.e. switch off the appliance.
- Remove the mains cable.
- Lay the appliance on its side.
- Lift and remove the front cover on the underside of the appliance (see Fig. 8).
- Remove the prefilter (a) from its holder.
- Remove the HEPA filter and active carbon filter from the appliance.
- Always remove the polyethylene bag from new filters!
- Insert the HEPA filter (b) and/or active carbon filter (c) into the Air Purifier (see Fig. 9).
- Insert the prefilter (a) in the same way it was removed earlier. In doing so, make sure that the lower retention lugs are pushed in from the top first, and then press in the remaining retention lugs.
- Replace the front cover (see Fig. 10)

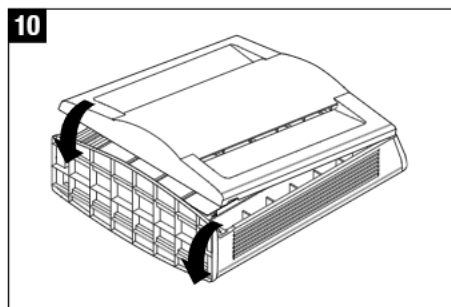
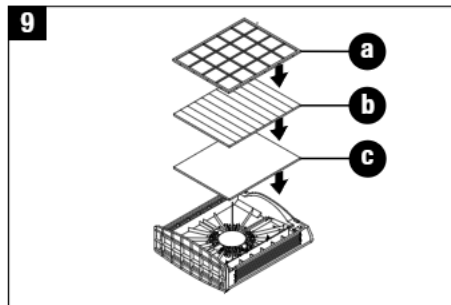
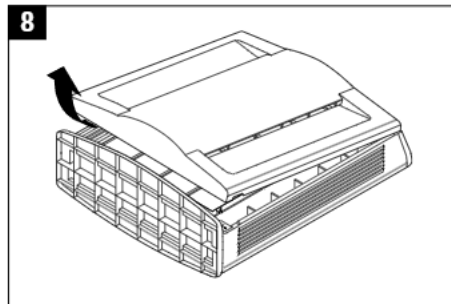

Replacing the battery in the remote control

Do this as shown in Fig. 11. You can also refer to the graphic on the rear of the remote control.

- Press lock 1 to the right and pull the battery holder out in direction 2.
- Insert a new battery (3V CR2032) into the battery holder.
- Make sure that the «+» symbol is face up and push the battery holder into the remote control.

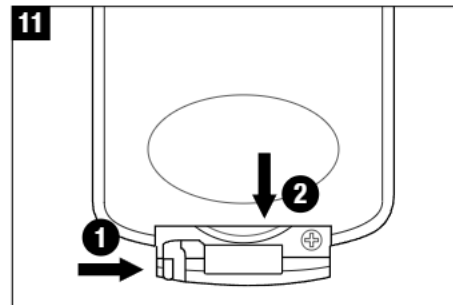

Cleaning/maintenance



Always remove the power cable from the mains socket first, to prevent any possible flow of current! Never allow the appliance to come into direct contact with water! Do not use aggressive cleaning agents!

Cleaning tips:

- Switch the appliance off (12).
- Remove the power plug from the mains socket before you clean the appliance (13).
- Wipe the housing with a damp, soft cleaning cloth, using a plastic cleaning agent as required (14).
- Clean the appliance, preferably after changing the filter.
- The filters must not come into contact with water. Please remove them before cleaning (15, 16).

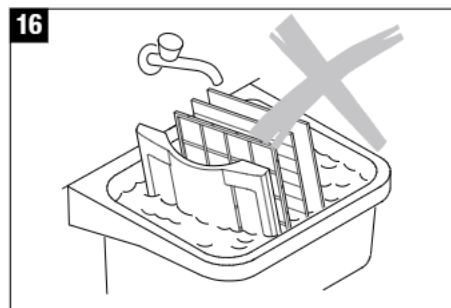
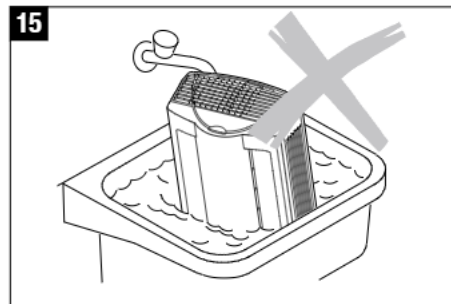
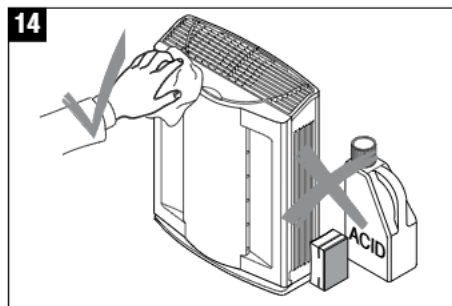
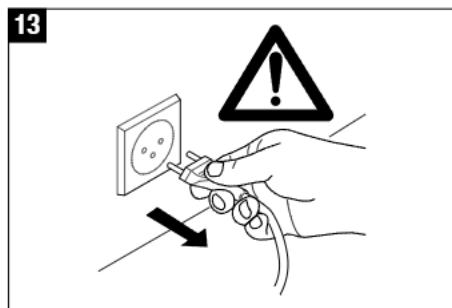
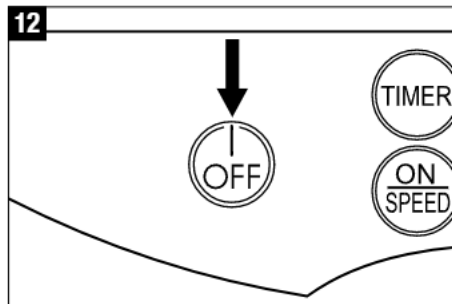

Storing the appliance when not in use

Remove and dispose of active carbon or HEPA filters that have been used for an extended period of time. Clean the housing as described and allow to dry out completely. Store the appliance in a dry place, preferably in the original packaging and away from excessive heat.

Disposing of the appliance and battery

Give your decommissioned appliance/battery to your dealer for proper disposal. For other disposal options, please refer to your local authority.



Warranty

The warranty conditions are established by our country representative. Should any problems arise with the Air Purifier despite strict quality checks, please approach your specialist dealer in confidence. Services under warranty can only be performed upon presentation of the original purchase receipt.

Technical specifications

Mains voltage	220 - 240 V / 50 Hz
Max. power consumption	150 W
Air circulation Mode 3	130 m ³ /h
Suitable for rooms up to	60 m ² / 150 m ³
Dimensions	380 x 160 x 465 mm
Weight (empty)	3.9 kg
Operating noise level Mode 1	25 dB (A)
Accessories	HEPA filter Active carbon filter

Spare parts

The spare parts listed below can be obtained from your specialist dealer and installed in the appliance yourself. Only original manufacturer's parts may be used.

HEPA filter Model no. A7014

Active carbon filter Model no. A7015

Legal notes

- The appliance is CE certified and complies with the Low Voltage Directive 73/23/EEC, and the Electromagnetic Compatibility Directives 89/336/EEC and 92/31/EEC.
- Subject to technical modifications.
- This user guide is protected by copyright.